

Your Exhibitor Hub Cheat Sheet

NY NOW

Think of the Exhibitor Hub as the place where all of your business with NY NOW lives. On a regular basis, you'll use this Hub to view invoices, make payments, and manage your contract. Closer to market, you'll submit your insurance, register your staff, review our Exhibitor Services Manual, and more.

Winter
2024

1 Log In

1. Go to winter24.smallworldlabs.com
2. Click the Login button
3. Click **Forgot Password?**
4. A new window will open, where you'll enter your email address to reset your password.

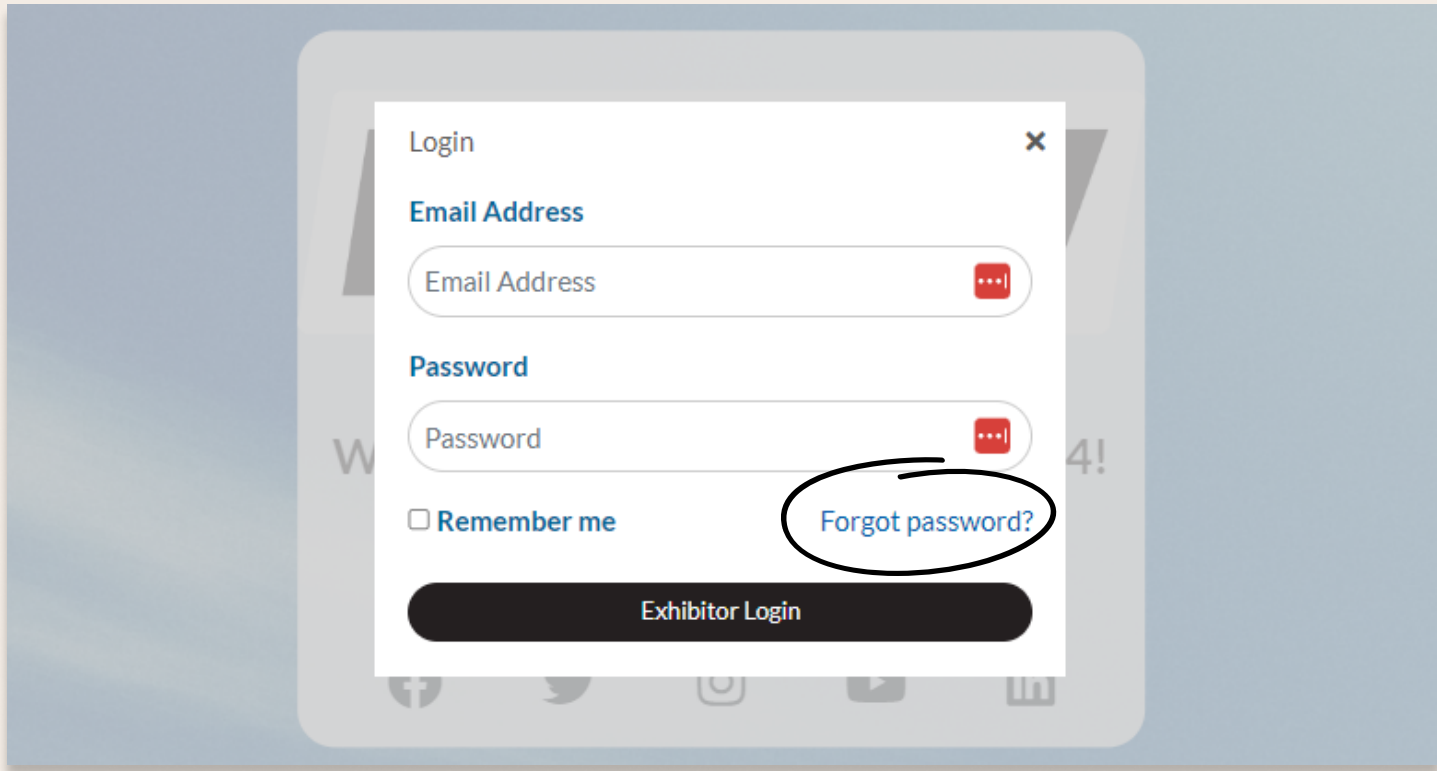

NOTE: YOU MUST ENTER THE SAME EMAIL ADDRESS USED IN YOUR NY NOW CONTRACT.

5. You will receive an automated email from admin@smallworldlabs.com with a link to reset your password – follow those instructions.
6. Return to winter24.smallworldlabs.com and log in with your email and new password.

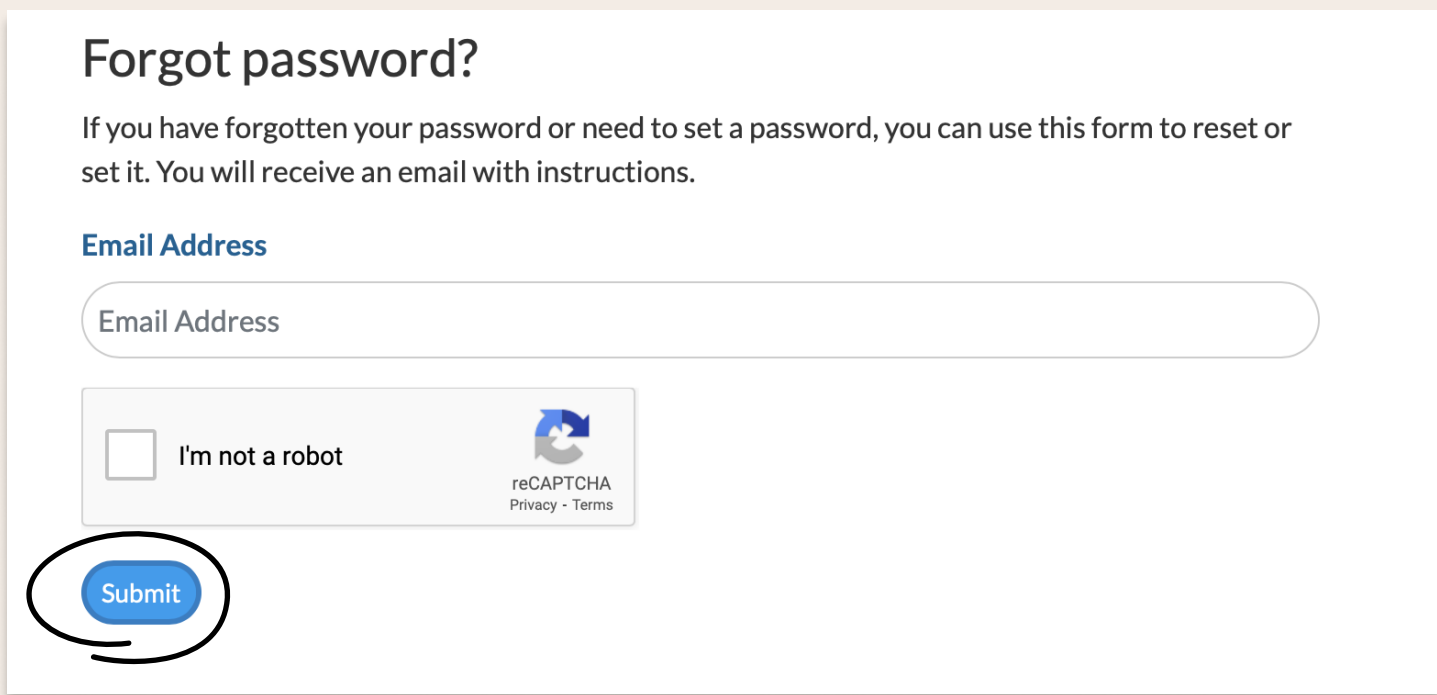

2 Access All NY NOW Business-Related Items

Once you've successfully logged in, click **EXHIBITOR HUB** in the top navigation bar. All of the below items and more are now easily accessible in one place:

- a. Access invoices
- b. Make payments
- c. Manage your contract
- d. Submit your insurance
- e. Register your staff
- f. Purchase sponsorship opportunities
- g. Review the Exhibitor Services Manual

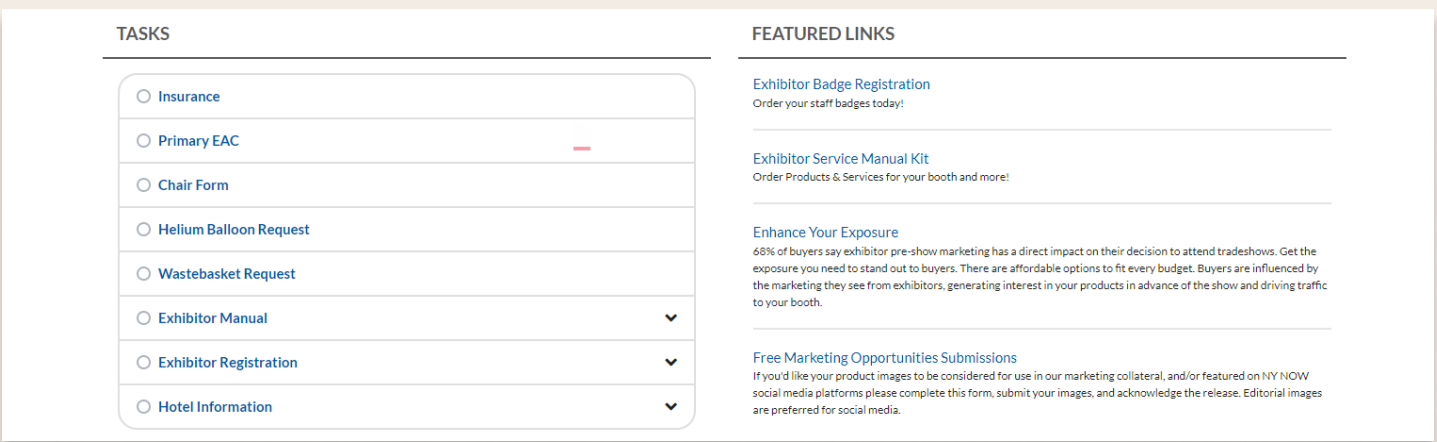
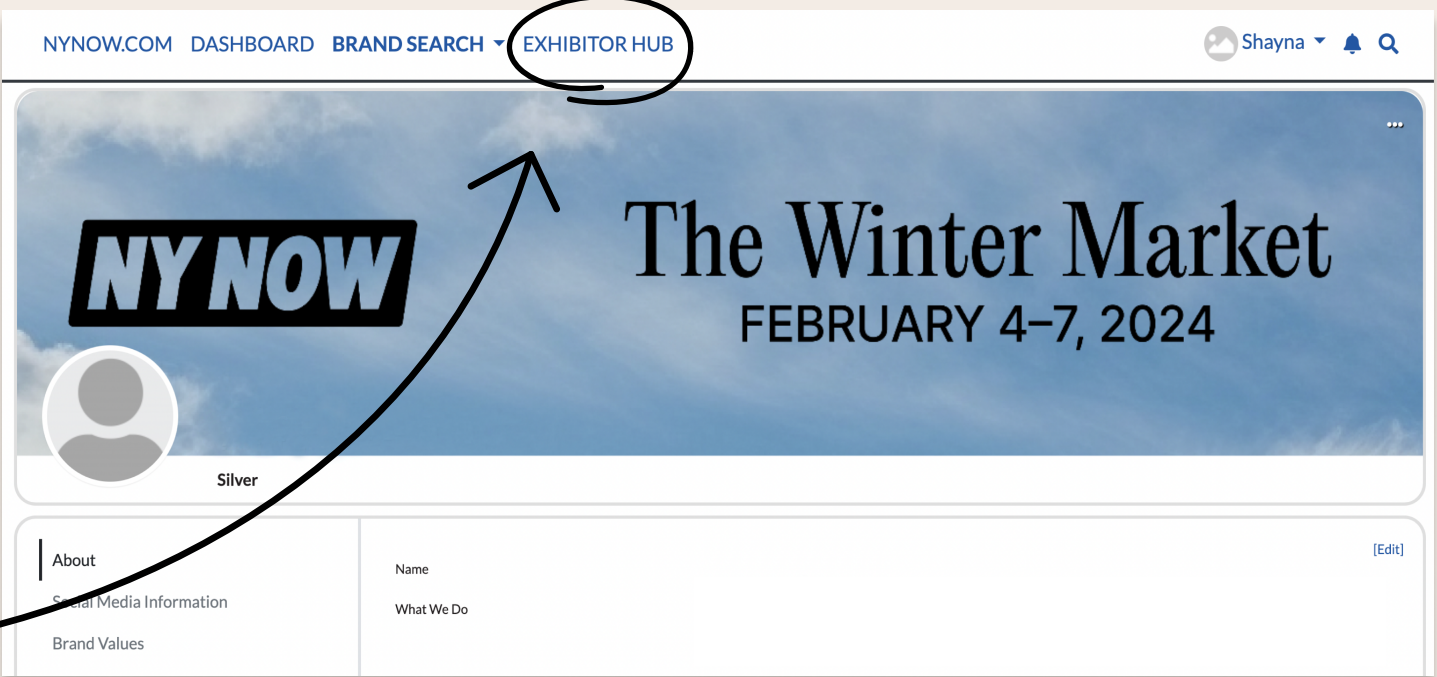

CONTACT US
support@nynow.com

FOLLOW US ON:



Winter Market
FEBRUARY 4-7, 2024